

Deep groove ball bearings, single row, seal on both sides

Principal dimensions			Basic load ratings		Fatigue load limit P_u	Speed ratings		Mass	Designation
d	D	B	dynamic	static		Reference speed	Limiting speed		
mm			kN		kN	r/min		kg	-
20	47	14	13,5	6,55	0,28	-	10000	0,11	6204-2RSH *

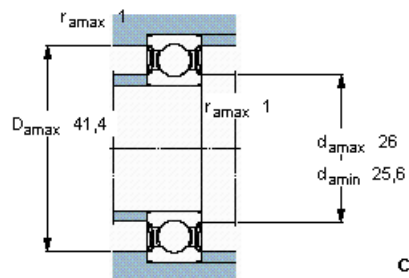
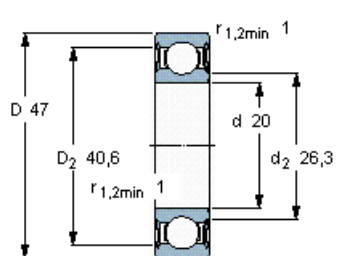

Calculation factors

$k_r = 0,025$

$f_0 = 13$